

Sunbeam

SLEEP EXPRESS ELECTRIC BLANKETS

BL48
BL49

User Guide

Sunbeam
SLEEP EXPRESS **PRO**
Electric Blanket

QUEEN FITTED

6 Heat Settings

Safety Auto Off

3X FASTER HEAT UP WITH PATENTED BOOST TECHNOLOGY™

Italian Technology & Elements

- 6 Heat Settings
- Safety Auto Off
- Digital Controller
- 1 to 5 Star Heat Up
- Machine Washable
- Mattress Protector
- Overheat Protection
- Lockdown Safety Guard
- Replacement Guarantee

BL4951

APPROX. 1500MM X 2000MM

Contents

Sunbeam's Safety Precautions	1
Safety Precautions for your Electric Blanket	2
Features of your electric blanket	3
Fitting your electric blanket	4
Fitting and using your control	5
Your 3 heat control	5
Your 6 heat control	6
Troubleshooting	7
Care and cleaning	8

Important instructions – retain for future use.

تأكد من تفهم احتياطات السلامة المذكورة اعلاه

請務必理解上述的安全預防措施。

Assurez-vous que les précautions ci-dessus relatives à la sécurité sont bien comprises

Versichern Sie sich, dass die obenstehenden Sicherheitsmaßnahmen Verstanden werden

Βεβαιώνετε πως οι παραπάνω προφυλάξεις ασφαλείας γίνονται κατανοητές

Pastikan bahwa tindakan-tindakan keselamatan seperti di atas dimengerti anda

Accertatevi che le suddette norme di sicurezza siano comprese a dovere

上記の注意事項をよくお読みになり、安全を御確認ください

Уверете се дека погоре споменатите мерки на претпазливост се добро разбрани

Asegúrese de que las precauciones de seguridad precedentes sean bien comprendidas

کاری بکنید کہ احتیاطهای بالا حتماً درک بشوند

ต้องแน่ใจว่า ข้อควรระวังเรื่องความปลอดภัยข้างต้น เป็นที่เข้าใจกันดี

Yukarda belirtilen güvenlik önlemlerinin anlaşıldığından emin olunuz

Xin kiểm chắc rằng những biện pháp làm an toàn kể trên được hiểu rõ

Sunbeam's Safety Precautions

Sunbeam is very safety conscious when designing and manufacturing consumer products, but it is essential that the product user also exercise care when using an electrical appliance. Listed below are precautions which are essential for the safe use of an electrical appliance:

- Read carefully and save all the instructions provided with an appliance.
- Always turn the power off at the power outlet before you insert or remove a plug. Remove by grasping the plug - do not pull on the cord.
- Turn the power off and remove the plug when the appliance is not in use and before cleaning.
- Do not use your appliance with an extension cord unless this cord has been checked and tested by a qualified technician or service person.
- Always use your appliance from a power outlet of the voltage (A.C. only) marked on the appliance.
- This appliance is not intended for use by persons (including children) with reduced physical, sensory or mental capabilities, or lack of experience and knowledge, unless they have been given supervision or instruction concerning use of the appliance by a person responsible for their safety.
- Children should be supervised to ensure that they do not play with the appliance.
- The temperature of accessible surfaces may be high when the appliance is operating.
- Never leave an appliance unattended while in use.
- Do not use an appliance for any purpose other than its intended use.
- Do not place an appliance on or near a hot gas flame, electric element or on a heated oven.
- Do not place on top of any other appliance.
- Do not let the power cord of an appliance hang over the edge of a table or bench top or touch any hot surface.
- Do not operate any electrical appliance with a damaged cord or after the appliance has been damaged in any manner. If damage is suspected, return the appliance to the nearest Sunbeam Appointed Service Centre for examination, repair or adjustment.
- For additional protection, Sunbeam recommend the use of a residual current device (RCD) with a tripping current not exceeding 30mA in the electrical circuit supplying power to your appliances.
- Do not immerse the appliance in water or any other liquid unless recommended.
- Appliances are not intended to be operated by means of an external timer or separate remote control system.
- This appliance is intended to be used in household and similar applications such as: staff kitchen areas in shops, offices and other working environments; farm houses; by clients in hotels, motels and other residential type environments; bed and breakfast type environments.

If you have any concerns regarding the performance and use of your appliance, please visit www.sunbeam.com.au or contact the Sunbeam Consumer Service Line.

Ensure the above safety precautions are understood.

Safety Precautions for your Electric Blanket

- Do not use your electric blanket on or under a waterbed.
- Do not use on an adjustable bed or futon.
- Do not switch the blanket on if moist or wet.
- Do not allow the blanket heating wires to lie over the edge of the mattress.
- Do not place your power cord or connector under any stress or strain. Never jam or bend the power cord over a hard surface such as a bed frame. The power cord should always remain free from obstructions.
- Do not use pins, needles, safety pins or other sharp items on your electric blanket.
- Do not dry clean your electric blanket.
- Use only as an underblanket.
- Examine periodically for signs of wear or damage on the blanket and on the blanket cords. If there are such signs, or the blanket has been misused, return it to an authorised service agent for inspection.
- Each day check that the electric blanket is smooth, flat and properly secured on the mattress. Do not use if the blanket is folded, rucked or creased.
- Only use your electric blanket with the controls supplied or marked equivalent.
- Do not use with infants, infirm persons, or persons insensitive to heat.
- Parents or guardians must preset the controls for young children, unless the child has been adequately instructed on how to operate the control safely.
- Turn the power off and remove the plug when the appliance is not in use and before cleaning.
- This electric blanket is not intended for use in hospitals.
- Should your appliance suffer a thermal or fuse link rupture (normally identified when the blanket stops heating) please return it to the manufacturer or agent for repair or replacement.
- When storing the appliance, allow it to cool down before folding.
- Do not crease the appliance by placing items on top of it during storage.
- Not to be used by very young children (0-3 years), infirm persons, or persons insensitive to heat.
- This appliance must not be used by persons insensitive to heat and other very vulnerable persons who are unable to react to overheating.
- Children under the age of three are not to use this appliance due their inability to react to overheating.

Important instructions – retain for future use.

If you have any concerns regarding the performance and use of your appliance, please visit www.sunbeam.com.au or contact the Sunbeam Consumer Service Line. Ensure the above safety precautions are understood.

Care Label Symbols



Attention



Instruction Booklet - Please read the instructions thoroughly before use

Features of your electric blanket

Boost Technology™

Sunbeam Sleep Express electric blankets, use patented Boost Technology™ and blanket elements which are exclusive to Sunbeam. Boost Technology™ innovation provides 3 x faster heat up than standard technology blankets (eg Sunbeam Harmony BL445U). Your bed will be warm and cosy in around 10 minutes, for a peaceful night's sleep

Fitted design

The 50cm fitted skirt and extra strong elastic cord keep the blanket flat and taut on the mattress, and make fitting easier.

Machine washable

The detachable controls and waterproof element make your electric blanket safe to machine wash and may be tumble dried. For Care and Cleaning instructions, see page 8.

Detachable controls

Always remove the controls when laundering your blanket. Store the controls during the summer months while your blanket remains on the bed as a comfortable underblanket.

Dual controls

Your Double, Double/Queen, Queen or King size electric blanket features two controls for individual comfort.

Fitting your electric blanket

Note: The heat pad is designed to fit within the edges of your mattress (see Figure 1). This ensures the best, smoothest and firm fit of your blanket to the mattress. As the blanket settles in to the fit of the bed, any fold ridges should smooth out over time.

Place the electric blanket on your mattress with the control sockets on the underside of the blanket near the head of the bed (see Figure 1). Ensure the heating wires do not extend under the pillows. A single or king single electric blanket can be turned over so that the control is on the preferred side of the bed if desired. Please note that this may result in the control facing towards the bed once the bed is made.

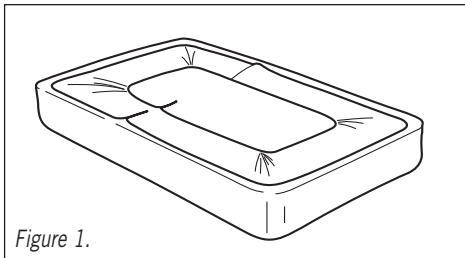

Pull the fitted skirt over the top corners of the mattress. To fit the foot of the bed, pull from the centre of the blanket to the foot of the bed, and fit one corner at a time while holding the centre (see Figure 2).

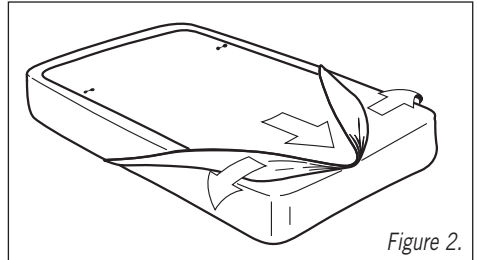

Ensure the fitted skirt is completely under the mattress. Pull on the edges of the blanket to ensure that it is flat and square on the mattress.

Fitting and using your control

Connecting the controls

To connect the controls, lift one corner of the blanket near the head of the bed to expose the connector socket (see Figure 3). Pass the control cord through the triangular hole in the fitted skirt and insert the connector plug into the socket. Ensure it is firmly clicked into position. Repeat on the other side if required. Plug the controls into a 230-240V power outlet and turn the power on.

Note: Ensure that the controls are connected to the blanket before inserting the power cord into the power outlet. Connecting the power before attaching the controls to the blanket will replicate a power interruption and activate the safety system, preventing your blanket from heating.

Caution: The cord and controls must be kept outside the bed and away from external heating sources such as heaters and lamps. Do not cover the control.

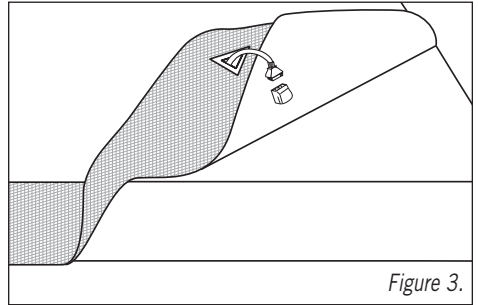

Before first use

Before using your electric blanket for the first time, Sunbeam recommends that you switch the blanket to maximum heat for two to three hours to evaporate any moisture in the mattress. Repeat this process every few months to maintain a dry, healthy bed.

Your 3 heat control

A choice of 3 heat settings, to keep you warm all night. Simply slide the control switch to your desired heat level.

- I Low, gentle heat
- II Medium heat
- III High heat. Recommended for preheating only. Do not sleep with your blanket on this setting for more than 30 minutes.

To turn off, simply slide the control switch to '0', and the illumination light will turn off.

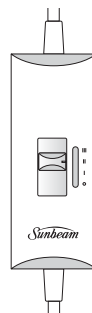

Your 6 heat control

Your electric blanket control has 6 heat settings. To turn on, simply slide the On /Off switch on the rear of the control to the on position (I). The control will illuminate, and the heat setting will initially automatically default to setting 5. To change the heat setting, simply push the Heat Settings button and it will cycle through the various temperature settings, from 1 through to 5, then back to 1.

You do not need to push the Boost button to activate the 3 x faster heat up Boost Technology. Whichever heat setting you choose, your electric blanket will be warm and cosy in around 10 minutes.

- 1 – 2 **Low**, gentle heat.
- 3 – 5 **Medium to high** heat
For All Night Use.
With Auto Off function
- 6 **Boost setting**. For preheating only.
Setting 6 is a manual setting, and should be used to preheat the bed only, Sunbeam does not recommend all night use. **There is no Auto Off function on setting 6.**

To turn off the control, simply slide the On / Off switch on the rear of the control to the off position. Ensure that the control is connected to the blanket properly.

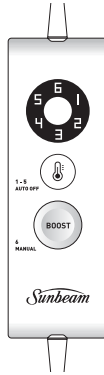

Boost Button

For fast heat up, simply push the Boost button, and the dial will change to setting 6. Your bed will heat up to the highest heat in around 10 minutes. The Boost button and setting 6 are to preheat the bed only and is not for all night use. **There is no Auto Off function on setting 6.**

To turn off the Boost button, so that you can change heat settings, and so that you can use the Safety Auto Off function, simply push the Boost button again. The heat setting will change from 6 to the previous heat setting used. To change the heat setting, push the heat setting button to cycle through the heat settings until you reach your desired temperature.

Safety Auto Off on the 6 heat control

Safety Auto Off function is only available on Settings 1 - 5. On settings 1 - 5, your electric blanket will automatically turn off after 9 hours, for peace of mind and energy savings.

To reactivate, simply slide the On/Off switch on the rear of the control to the on position.

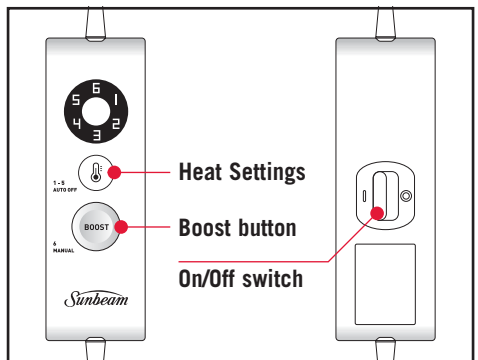

Troubleshooting

The electric blanket is not heating	<p>Check the control is plugged into the electric blanket, and ensure it is clicked securely into position. If the control connector is not properly fitted to the blanket, switch the power off at the power outlet, securely attach the control connector plug to the blanket and then switch the power back on.</p>
	<p>Check the power cord is connected to the power outlet and that the power is switched on.</p>
	<p>If you have the 6 heat control, check that the On/Off switch located on the back of control is set to the On position.</p>
	<p>If only one side of the blanket is working, it may simply be because the control rather than the blanket is not working. To help resolve your issue quickly, before calling Sunbeam Customer Service, please check the control. Simply swap the “good controller” to the “faulty” side of the blanket. Wait 20 minutes to see if the blanket is heating. If it does heat, the first controller is faulty. If the blanket still does not heat, the blanket may be faulty. Then call Sunbeam Customer Service line, and they will be able to assist.</p>
	<p>Remember for double, queen and king blankets there are 2 controls. Ensure both are plugged into the blanket, and both cords are plugged into a power outlet.</p>
	<p>If you are using a powerboard, use one with a safety cut out. Check to see if the powerboard is working, by plugging your blanket into a different powerpoint.</p>
The cord or any wiring is damaged	<p>Do not attempt to repair it yourself. Contact the Sunbeam Customer service line on 1300 881 861 in Australia or 0800 786 232 in New Zealand.</p>

Care and cleaning

All Sleep Express electric blankets feature waterproof heating elements, making them fully immersible and safe to wash by hand or machine.

Before cleaning your electric blanket, ensure that the controls are unplugged from the blanket.

Spot cleaning

Sponge the affected area using a neutral wool detergent or mild soap flakes mixed with lukewarm water. Sponge twice with clean water to remove detergent. Remove excess water by compressing the wet area between two towels.

Hand washing

Wash the blanket in lukewarm water with a neutral wool detergent or mild soap flakes. Soak for five minutes, then gently squeeze the soapy water through the fabric. Rinse thoroughly in clean, lukewarm water then drain excess water from the blanket. Do not wring.

Machine washing

Take your electric blanket to a commercial laundry or wash in a domestic washing machine (size permitting). Wash on WOOL or DELICATES cycle with a neutral wool detergent or mild soap flakes, below 40°C. Do not use high speed or extra spin cycles.

Line drying

Drape the blanket across several lines of your clothesline, and try to avoid direct heat. Do not use pegs on the wired areas. Do not dry with a hairdryer or heater. Ensure that the blanket and control sockets are completely dry before using again.

Machine drying

Tumble dry your blanket on LOW setting for 15 minutes MAXIMUM. Smooth the blanket by gently pulling any creases out of the fabric. Line dry to ensure the blanket and control sockets are completely dry before use. Do not dry with a hairdryer or heater.

Storing your blanket

Your blanket can remain on the bed all year round as a comfortable underblanket. Simply remove the controls and store until winter. If you wish to remove the blanket from your bed when not in use, roll or fold it loosely and store in a blanket bag or the bag it was supplied in. Avoid pressing sharp creases into the blanket.

Do not place heavy items on top of your electric blanket when storing.

When storing the electric blanket, allow it to cool down before folding.

3

Year

Replacement Guarantee

This Sunbeam product is covered by a 3 year replacement or repair warranty, which is in addition to your rights under the Australian Consumer Law (if your product was purchased in Australia) or New Zealand Consumer Guarantees Act (if your product was purchased in New Zealand).

Upon receipt of your claim, Sunbeam will seek to resolve your difficulties or, if the product is defective, advise you on how to obtain a replacement or refund.

To assist us in managing warranty claims, we recommend you register your product as soon as practicable after purchase by creating a MySunbeam account on our website and uploading a copy of your original receipt.

In order to make a claim under our warranty, you must have the original proof of purchase documentation for the product and present it when requested (if not already uploaded to our website).

Should your product develop any defect within 3 years of purchase because of faulty materials or workmanship, we will replace or repair it, at our discretion, free of charge. A product presented for repair may be replaced by a refurbished product of the same type rather than being repaired. Refurbished parts may be used to repair the product.

Our replacement or repair warranty only applies where a defect arises as a result of faulty material or workmanship during the warranty period. Your warranty does not cover misuse or negligent handling (including damage caused by failing to use the product in accordance with this instruction booklet), accidental damage, or normal wear and tear.

Your warranty does not:

- cover freight or any other costs incurred in making a claim, consumable items, accessories that by their nature and limited lifespan require periodic renewal (such as filters and seals) or any consequential loss or damage; or

- cover damage caused by:
 - power surges, power dips, voltage supply problems, or use of the product on incorrect voltage;

- servicing or modification of the product other than by Sunbeam or an authorised Sunbeam service centre;
- use of the product with other accessories, attachments, product supplies, parts or devices that do not conform to Sunbeam specifications; or
- exposure of the product to abnormally corrosive conditions; or

- extend beyond 3 months if the product is used in commercial, industrial, educational or rental applications.

The benefits given to you by our warranty are in addition to other rights and remedies under law in relation to the product.

In Australia our goods come with guarantees that cannot be excluded under the Australian Consumer Law. You are entitled to a replacement or refund for a major failure and for compensation for any other foreseeable loss or damage. You are also entitled to have the goods repaired or replaced if the goods fail to be of acceptable quality and the failure does not amount to a major failure.

Our goods also come with guarantees that cannot be excluded under the New Zealand Consumer Guarantees Act.

If your warranty claim is not accepted, we will inform you and if requested to do so by you, repair the product provided you pay the usual charges for such repair. You will also be responsible for all freight and other costs.

Should your product require repair or service after the warranty period, contact your nearest Sunbeam service centre. For a complete list of Sunbeam's service centres, visit our website or call our customer service line for advice on 1300 881 861 in Australia, or 0800 786 232 in New Zealand.

Should you experience any difficulties with your product during the warranty period, please contact our customer service line for advice on 1300 881 861 in Australia, or 0800 786 232 in New Zealand.

Australia

www.sunbeam.com.au
1300 881 861
Units 5 & 6,
13 Lord Street,
Botany NSW 2019
Australia

New Zealand

www.sunbeam.co.nz
0800 786 232
Level 6, Building 5,
Central Park,
660-670 Great South Road,
Greenlane, Auckland
New Zealand

Need help with your appliance?

Contact our customer service team or visit our website for information and tips on getting the most from your appliance.

Australia | visit www.sunbeam.com.au
phone 1300 881 861
mail Units 5 & 6, 13 Lord Street,
Botany NSW 2019 Australia.

New Zealand | visit www.sunbeam.co.nz
phone 0800 786 232
mail Level 6, Building 5,
Central Park,
660–670 Great South Road,
Greenlane, Auckland.

Sunbeam Corporation Limited | ABN 45 000 006 771

Sunbeam Corporation is a division of GUD Holdings Limited.

Sunbeam is a registered trade mark.

Sleep Express and Boost Technology are trade marks of Sunbeam Corporation.

Made under license of Australian Patent No. AU2013203697 (B2),
and New Zealand Patent No. NZ609279 (A)

Made in China to Sunbeam's specification.

Due to minor changes in design or otherwise,

the product you buy may differ slightly from the one shown here.

Approved by the appropriate electrical regulatory authorities.

©Copyright Sunbeam 2016.